

# User Manual

## AMD Socket AMD FM1, AM2, AM2+, AM3

### Igloo A360 Series (Fan with Ultra Entering Bearing)



Inspiring Cooling Technology  
www.GlacialTech.com

#### •Specifications

| Model                 | Igloo A360 Silent (U)  | Igloo A360 Light (U)   | Igloo A360 (U) | Igloo A360 PWM (U) |                                   |
|-----------------------|--|------------------------|----------------|--------------------|-----------------------------------|
| Socket Type           | AMD FM1, AM2, AM2+, AM3  |                        |                |                    |                                   |
| CPU Compatibility     | A4-3400, A6-3650, A8-3850 (100W)<br>Phenom™ II X2, X3, X4, and X6 Processors (125W)<br>Phenom™ X3, X4 Cores Processors (125W)<br>Athlon™ II X2, X3, X4 Processor (95W) |                        |                |                    |                                   |
| Cooler Dimension (mm) | 84.5(W)×84.5(L)×52.3(H)  |                        |                |                    |                                   |
| Cooler Weight (grams) | 270  |                        |                |                    |                                   |
| Fan                   | Bearing Type   | Ultra Entering Bearing |                |                    |                                   |
|                       | Rated Voltage  | DC 12V                 |                |                    |                                   |
|                       | Dimension (mm)   | 80 x 80 x 25           |                |                    |                                   |
|                       | MTBF(hour/25°C)  | 50,000                 | 50,000         | 50,000             | 50,000                            |
|                       | Speed (RPM)  | 2,000 (±10%)           | 2,600 (±10%)   | 3,200 (±10%)       | PWM 800(±300 RPM)~<br>3,600(±10%) |
|                       | Airflow (CFM)  | 26                     | 35.5           | 44.1               | Max.50                            |
|                       | Noise (dBA)  | 20                     | 25             | 32                 | 15~38                             |
| Interface Material    | High Efficiency Thermal Compound   |                        |                |                    |                                   |

- Approved by CE & UL Certificate
- The company has retained the rights and interests of amendments to the product specification sheet, referred to the marks and names of the respective companies of all

#### •Installation



##### Step 1

Hook one side of clip on the RM.

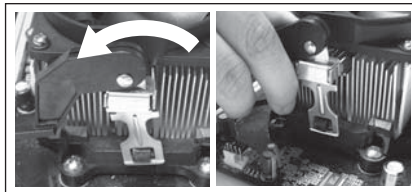

##### Step 2

Turn the clip to the left and hook the clip on the RM.

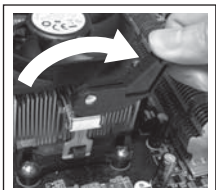

##### Step 3

Turn the clip to the right and fix the heatsink to the RM

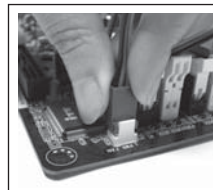

##### Step 4

Plug the 3-pin (4-pin for PWM) fan power connector into the on-board 12V power connector.

Made in China

**GlacialTech®**  
*Enlighten Your Humanity*

9F, No. 352, Sec. 2, Zhongshan Rd., Zhonghe Dist., New Taipei City, Taiwan, 235, R.O.C.  
TEL: +886 2 2244-1227 FAX: +886 2 2244-1228 E-mail: sales@glacialtech.com

For further information, please consult our website: [www.GlacialTech.com](http://www.GlacialTech.com)  
©2011 GlacialTech Inc. All rights reserved. All brand names and trademarks are the properties of their respective owners.

The specifications are subject to change without notice.

17-A360S000002