

User Manual

AMD Socket AMD FM1, AM2, AM2+, AM3



Inspiring Cooling Technology
www.GlacialTech.com

Igloo A360CU Series (Fan with Ultra Entering Bearing)

•Specifications

Model	Igloo A360CU Silent (U)	Igloo A360CU Light (U)	Igloo A360CU(U)	Igloo A360CU PWM (U)	
Socket Type	AMD FM1, AM2, AM2+, AM3				
CPU Compatibility	A4-3400, A6-3650, A8-3850 (100W) Phenom™ II X2, X3, X4, and X6 Processors (140W) Phenom™ X3, X4 Cores Processors (125W) Athlon™ II X2, X3, X4 Processor (95W)				
Cooler Dimension (mm)	84.5(W)×84.5 (L)×62.3(H)				
Cooler Weight (grams)	355				
Fan	Bearing Type	Ultra Entering Bearing			
	Rated Voltage	DC 12V			
	Dimension (mm)	80 x 80 x 25			
	MTBF(hour/25°C)	50,000	50,000	50,000	50,000
	Speed (RPM)	2,000 (±10%)	2,600 (±10%)	3,200 (±10%)	PWM 800(±300 RPM)~3,600(±10%)
	Airflow (CFM)	26	35.5	44.1	Max.50
	Noise (dBA)	20	25	32	15~38
	Interface Material	High Efficiency Thermal Compound			

- Approved by CE & UL Certificate
- The company has retained the rights and interests of amendments to the product specification sheet, referred to the marks and names of the respective companies of all

•Installation



Step 1

Hook one site of clip on the RM.

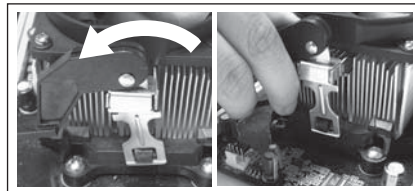

Step 2

Turn the clip to the left and hook the clip on the RM.

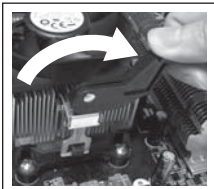

Step 3

Turn the clip to the right, and fix the heatsink to the RM



Step 4

Plug the 3-pin (4-pin for PWM) fan power connector into the onboard 12V power connector.

Made in China

GlacialTech®
Enlighten Your Humanity

9F, No. 352, Sec. 2, Zhongshan Rd., Zhonghe Dist., New Taipei City, Taiwan, 235, R.O.C.
TEL: +886 2 2244-1227 FAX: +886 2 2244-1228 E-mail: sales@glacialtech.com

For further information, please consult our website: www.GlacialTech.com

©2011 GlacialTech Inc. All rights reserved. All brand names and trademarks are the properties of their respective owners.

The specifications are subject to change without notice.

17-A360SCU0001