

# User Manual

## AMD Socket AMD FM1, AM2, AM2+, AM3



Inspiring Cooling Technology  
www.GlacialTech.com

### Igloo A330 Series (Fan with Ultra Entering Bearing)

#### •Specifications

Model	Igloo A330 Silent (U)	Igloo A330 Light (U)	Igloo A330 (U)	Igloo A330 PWM (U)	
Socket Type	AMD FM1, AM2, AM2+, AM3				
CPU Compatibility	A4-3400, A6-3650, A8-3850 (100W) Phenom™ II X2, X3, X4, and X6 Processors (95W) Phenom™ X3, X4 Cores Processors (95W) Athlon™ II X2, X3, X4 Processor (95W)				
Cooler Dimension (mm)	76.5(W)×76.5 (L)×52.3(H)				
Cooler Weight (grams)	220				
Fan	Bearing Type	Ultra Entering Bearing			
	Rated Voltage	DC 12V			
	Dimension (mm)	80 x 80 x 25			
	MTBF(hour/25°C)	50,000	50,000	50,000	50,000
	Speed (RPM)	2,000 (±10%)	2,600 (±10%)	3,200 (±10%)	PWM 800(±300 RPM)~ 3,600(±10%)
	Airflow (CFM)	26	35.5	44.1	Max.50
	Noise (dBA)	20	25	32	15~38
Interface Material	High Efficiency Thermal Compound				

- Approved by CE & UL Certificate
- The company has retained the rights and interests of amendments to the product specification sheet, referred to the marks and names of the respective companies of all

#### •Installation

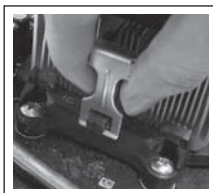

##### Step 1

Hook one site of clip on the RM.

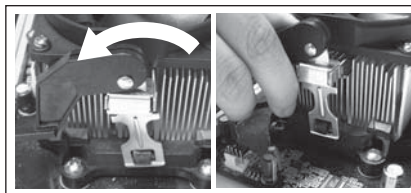

##### Step 2

Turn the clip to the left and hook the clip on the RM.

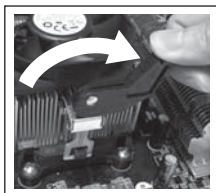

##### Step 3

Turn the clip to the right, and fix the heatsink to the RM

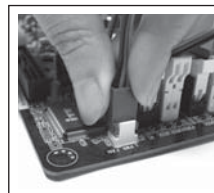

##### Step 4

Plug the 3-pin (4-pin for PWM) fan power connector into the onboard 12V power connector.

Made in China

**GlacialTech®**  
Enlighten Your Humanity

9F, No. 352, Sec. 2, Zhongshan Rd., Zhonghe Dist., New Taipei City, Taiwan, 235, R.O.C.  
TEL: +886 2 2244-1227 FAX: +886 2 2244-1228 E-mail: sales@glacialtech.com

For further information, please consult our website: www.GlacialTech.com  
©2011 GlacialTech Inc. All rights reserved. All brand names and trademarks are the properties of their respective owners.

The specifications are subject to change without notice.

17-A330S000002