

# GL-LED Panel Light V2 Series (Clip) User's Manual

Thank you for choosing the GL-PL-V2 Series LED products. Please install and use the products according to the following directions to ensure normal function and operation. Please use stainless screw to fix holder and make sure screwed tightly. Please do not add/remove any electrical components to/from the products or change/tamper the original electrical design without our permission. Please do not add/remove any mechanical components to/from the products or change/tamper the original mechanical design without our permission. If you do not follow these instructions to properly install and use the GL-PL-V2 Series, you will not be eligible for warranty compensation or protection. We do not take any responsibility for product damage resulting from improper installation or abnormal usage.

## \* For 3 in 1 dimmable function

- "DIM+ / DIM-" Connecting a variable resistor (10K~100K resistor) / 1~10Vdc Direct Voltage or a 10V / PWM signal can adjust the dimmable lighting.
- Connecting "DIM+ / DIM-" to "AC L / AC N" may damage the Lighting.
- When the control cable "DIM+ / DIM-" is open, LED Light output is 100%.
- The 3 in 1 Dimmer is not capable of turning off the LED light completely. To turn off the light, we would recommend you to use the dimmer with a switch.



For detailed 3 in 1 dimmable function description, please visit the web site:  
<http://www.glaciallight.com/products/PDF/3in1Dimming-Function.pdf>

## Installation Guidelines

- 1 Unpack the LED Panel Light-V2 from the packaging box.

- 2 Take out the LED driver and the LED Panel Light-V2 with caution.

- 3 Remove the screws on the back of LED Panel Light-V2 depicted in the picture.

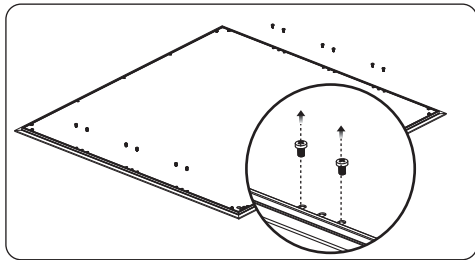

- 4 Lock the clips in place by screws.

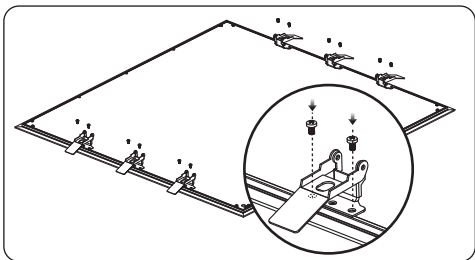

- 5 Connect the LED driver and the LED Panel Light-V2 into the DC power cord connector.  
Do not connect the LED Panel Light-V2 into any other non-compatible LED driver which may cause product damage.

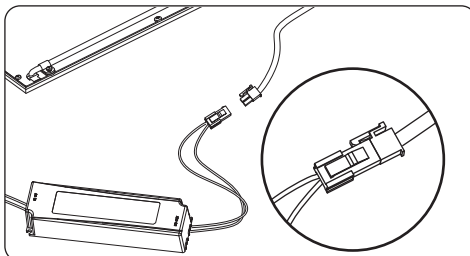

※ The DC power cord connector should be properly connected, not loose.

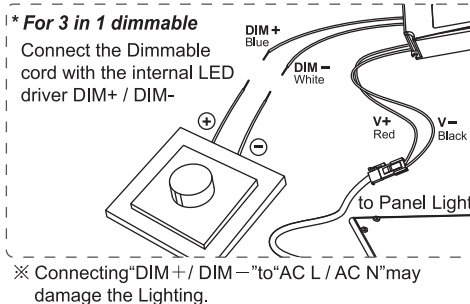

- 6 Turn off the main power source before installation to avoid electric shock.  
Then properly insert Line (L) and Neutral (N) into the AC power connector.

- 7 The AC power connector should be properly connected, not loose.

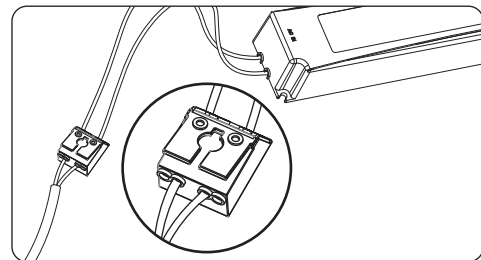

- 8 Fasten one side of clips on the ceiling hole and the other side also.  
(Note: Two people are needed to install the panel light-V2.)

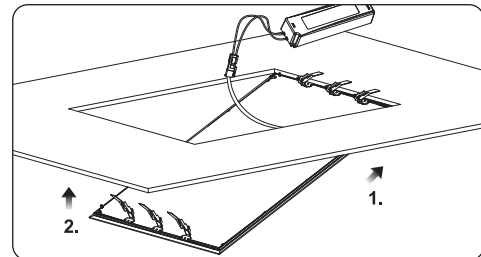

- 9 Turn on the AC power to light up the LED Panel Light-V2.

## Fixture Hole

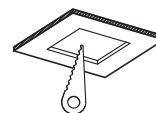

| Type      | Hole Size  |
|-----------|------------|
| PL0303-V2 | 300x300mm  |
| PL0606-V2 | 600x600mm  |
| PL0312-V2 | 300x1200mm |

## Instructions

To ease the installation process and ensure the optimal performance of the product, carry out the installation procedure in compliance with the following safety regulations.

- Unpack carefully and ensure there is no product damage during shipping. Should the product be found damaged during shipping, please return it to your supplier.
- Unless otherwise specified, never connect the device with any dimmer switch.
- All the electrical wiring necessary for the proper installation of the LED Panel Light is supposed to be conducted by qualified personnel to prevent electric shock or product damage.
- Avoid humidity. Should the LED Panel Light be moistened by any liquid or fluid that may conduct electricity, immediately disconnect it from the power source.
- In case of a malfunction, turn off the power source immediately. Never try to repair the LED Panel Light by yourself which may cause serious damage and void your warranty. Instead, contact your local dealer for technical assistance.
- Please recycle the package.

## Lamp

- Never touch the luminaire when it turns on or gets hot.
- Unless otherwise specified, never use LED luminaires in humid environments.
- Appropriate ambient temperature: -20 to 40°C.

## Troubleshooting

- One of the following problems may appear while you use the LED lamp.
  - \* No light : Check whether your LED lamp and all other accessories are properly fitted into the fixture adequately connected to the specified power source.
  - \* Fixture Cleaning : To optimize the light output, we recommend that you periodically clean the internal and external optical lenses as well as the reflection mirrors. Only use a dry soft cloth, a dust brush or a vacuum cleaner and never use any liquid chemical cleaner or water to clean the lamp.

## CAUTIONS

1. If the external flexible cable or cord of this luminaire is damaged, it shall be exclusively replaced by the manufacturer or his service agent or a similar qualified person in order to avoid a hazard.
2. Prior to installation, remove the AC power.



©2015 GlacialTech Inc. All rights reserved. All brand names and trademarks are the properties of their respective owners.  
 The specifications are subject to change without notice.

For further information please visit official website : [www.GlacialLight.com](http://www.GlacialLight.com)



17-PLXXSV20011

# GL-PL V2 平板燈系列(扣具)使用手冊

感謝您選擇使用 GL-PL-V2 系列LED燈具。請您依據下列說明指示來安裝本產品，以確保本產品的正常運作。請使用不鏽鋼螺絲固定支架，並確實鎖緊。請勿增加或刪除任何電子元件，未經許可勿更改或修改電氣設計。請勿增加或刪除任何機構元件，未經許可勿更改或修改機構設計。如您未按說明指示妥善安裝以及正常使用 GL-PL-V2，您的產品將無法得到正常的保修補償。不正常的安裝與使用所造成的產品損壞，本公司具免責權利。

## \* 3合1調光功能說明

- 在DIM+和DIM-之間連接一個可變電阻(10K~100K resistor)或連接1~10Vdc直流電壓或10V/PWM信號，可調整亮度。
- 勿將DIM+/DIM-與AC L/AC N相連接，這樣會造成LED驅動器損壞。
- 當控制線DIM+/DIM-開路(open)時，亮度輸出為100%。
- 3合1調光驅動器不能將LED照明完全關閉(0%)，要達到LED照明完全關閉(0%)建議使用含有開關(SW)的調光器。



相關詳細3合1調光功能說明，請至：  
<http://www.glaciallight.com/products/PDF/3in1Dimming-Function.pdf>

## 安裝指南

- 1 拆解GL-PL-V2 平板燈包裝箱。
- 2 將LED電源驅動器與GL-PL-V2平板燈小心地取出包裝箱。
- 3 將背版螺絲依圖示拆卸下。

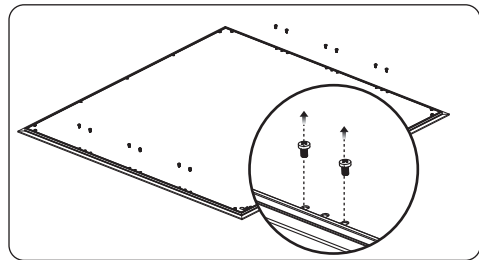

- 4 將扣具對齊螺絲孔放好，鎖回螺絲。

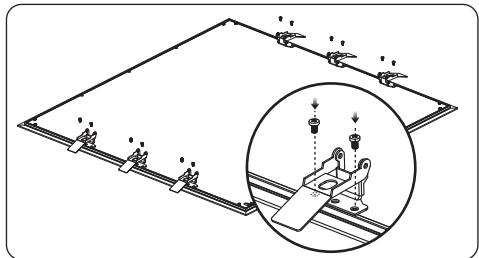

- 5 將LED電源的DC輸出連接器與平板燈相連接。切勿將LED平板燈接上任何不匹配的電源驅動器以免造成產品毀損。

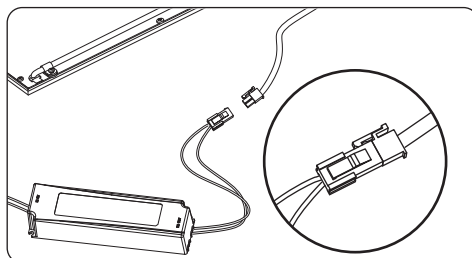

※ 連接器接應妥善接合，不可鬆動。

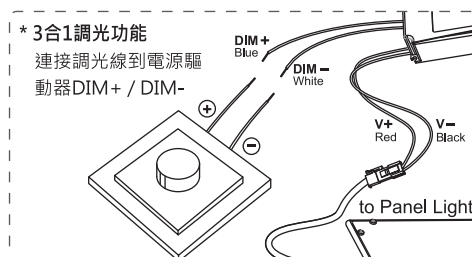

※ 勿將DIM+/DIM-與AC L/AC N相連接，這樣會造成LED驅動器損壞。

- 6 安裝GL-PL-V2平板燈前應先將主電源關閉以避免安裝人員觸電。將交流電源線接至LED電源驅動器的AC輸入L(黑)/棕，N(白)/藍。

- 7 承上，應妥善將交流電源線連與LED電源驅動器AC端相接，不可鬆動。

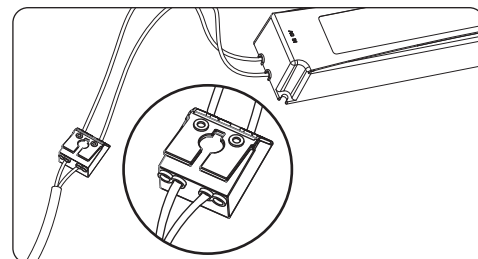

- 8 先將一邊扣具置於挖好的孔內扣緊後，再將另一邊扣具扣上。(此步驟建議2人同時施工)

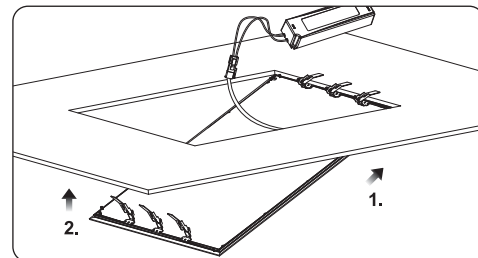

- 9 啟動開關點亮GL-PL-V2 平板燈。

## 型號對照挖孔尺寸

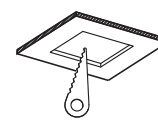

| 型號        | 挖孔尺寸       |
|-----------|------------|
| PL0303-V2 | 300x300mm  |
| PL0606-V2 | 600x600mm  |
| PL0312-V2 | 300x1200mm |

## 指示說明

為了本產品安裝便利性與產品最佳表現，請遵照下列安全規定執行安裝。

- 小心地拆卸包裝並確認運送過程中產品無造成損害。若發現任何運送損害請退回給供應廠商。
- 除特別指定，勿將本產品連接至調光開關。
- 任何關於電氣特性的連接或安裝，請委由合格的施工人員進行，以避免人員或產品傷害。
- 任何因液體接觸造成本產品潮溼皆會有導電情況，請即刻移除電源。
- 萬一發生故障，請即刻關閉電源。切勿試圖自行修復本產品否則將可能導致產品嚴重損壞與喪失保固。應聯絡您的經銷商尋求技術協助。
- 請回收包裝材料。

## 燈具使用注意事項

- 燈具點亮或發熱時，請勿觸碰燈具。
- 除特別指定，不要將燈具安裝在潮溼的環境。
- 適合安裝的環境溫度為 -20~40°C。

## 故障排除

- 當你使用燈具時，可能會出現以下問題。
  - \* 燈具不亮：  
請檢查燈具的電源線是否適切地連接。
  - \* 燈具清潔：  
建議週期性地以乾軟布擦拭、塵刷或吸塵器清潔燈具，勿用水或化學液體清潔燈具。

## 警告

1. 如果燈具外部纜線有損壞，應當由製造商、代理商或符合資格的施工人員做更換，以避免危險。
2. 安裝前，請確實關閉交流電源。



BR